

Components for Tiling Shower Tray Tape

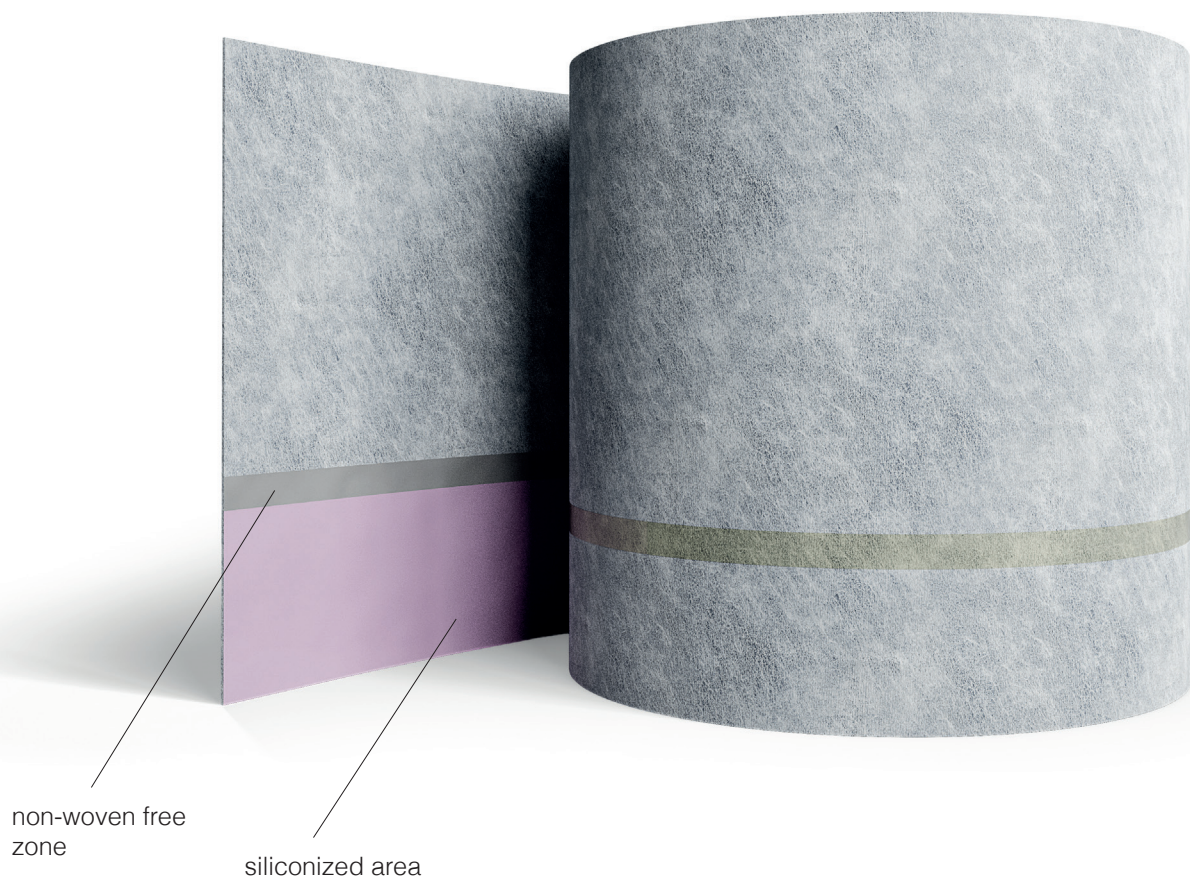

Components for Tiling Shower Tray Tape

**Reliable shower tray sealing.
It does not get any easier!**

- Additional adhesive strip as installation aid (optional)
- Extremely strong adhesion to silicone
- Easy application
- Good compatibility with all processing materials
- Very flexible
- Alkali-resistant
- Referring to the DIN 18534

Product description

Sealing tape for watertight connection between shower- or bathtubs and the surface sealant. The tape is equipped with a siliconized strip that provides extreme adhesion to silicone. No water can migrate!

Application area

All shower- and bathtubs, which have to be connected to walls in a watertight manner.

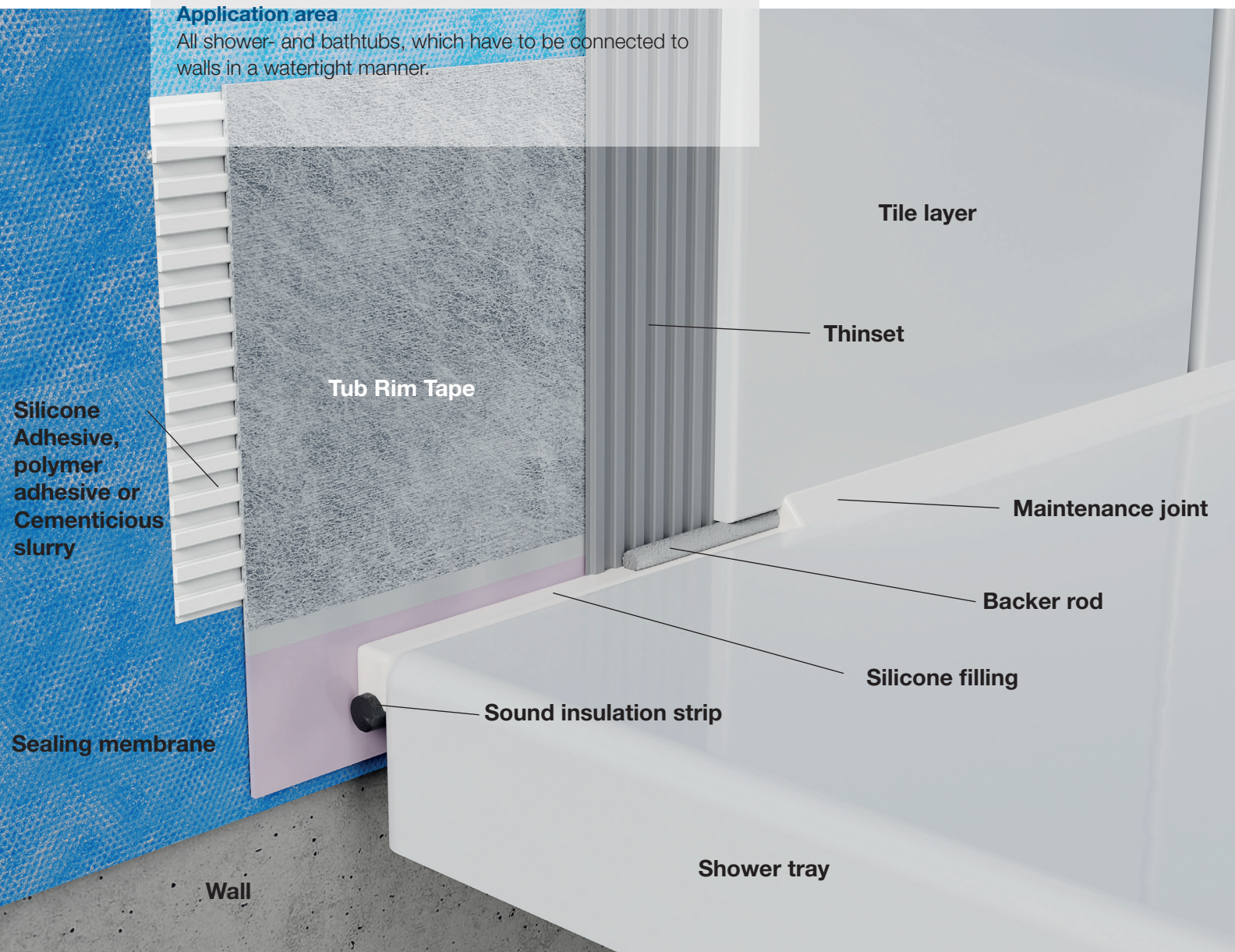

Installation

The sealing of the surface has already been done with compatible products. Now determine the intended final position of the shower- or bathtub. Mark a distance of 75 mm above the tub rim.

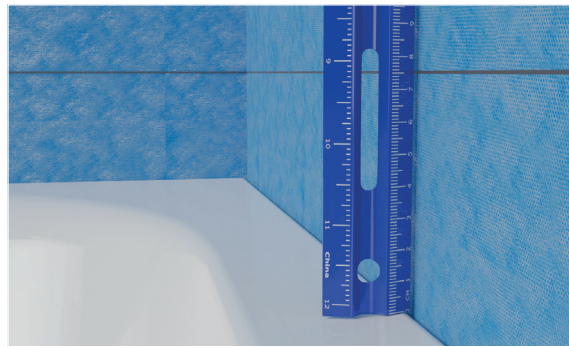

Place the tape with the top edge along the previously made marks. The adhesive strip on the backside ensures an easy fixation of the tape.

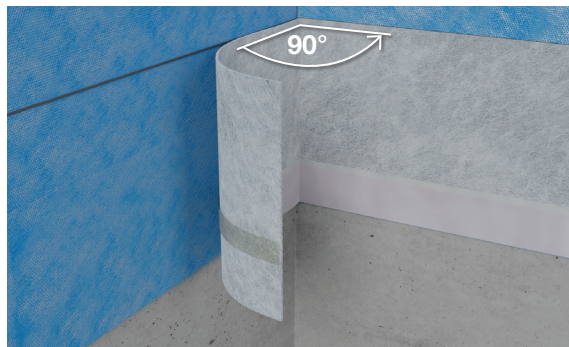

The tape can now be adhered to the underlying surface with a cementitious slurry, polymer adhesive or silicone adhesive, in a watertight manner.

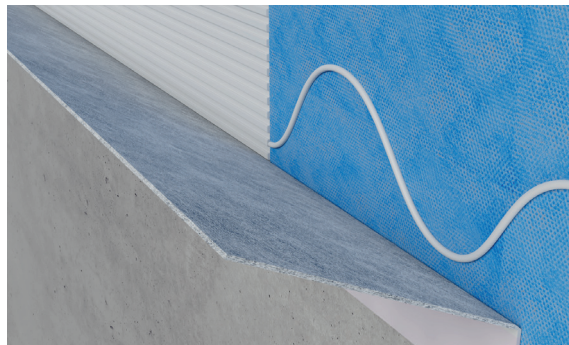

Now attach a sound insulation strip to the faces of the bathtub which later come into contact with the wall. Please make sure to leave at least 5 mm space to the upper edge for the silicone filling.

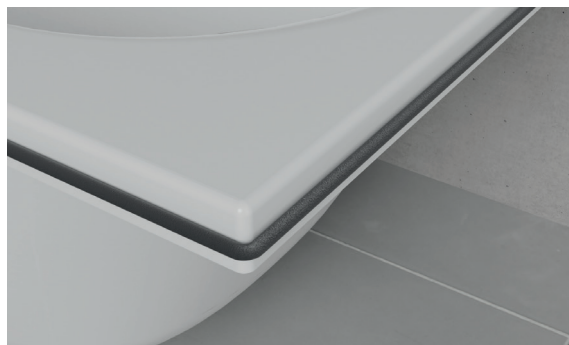

To firmly connect the tape with the tub-/ shower tray, please fill the gap and especially the corner area, sufficiently with silicone glue. The siliconized strip enables a very strong connection to the silicone. Smoothen the silicone compound so that it is level with the tub.

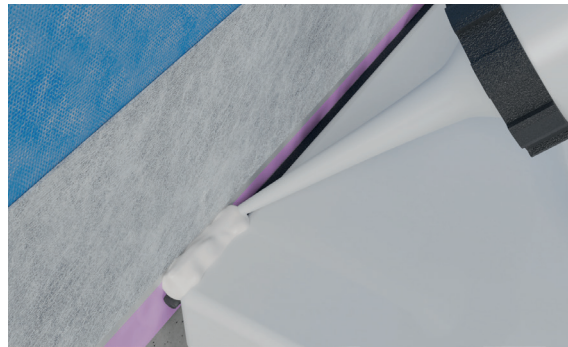

Now you can start tiling. Afterwards, install the expansion joint avoiding a 3-flank adhesion of the joint.

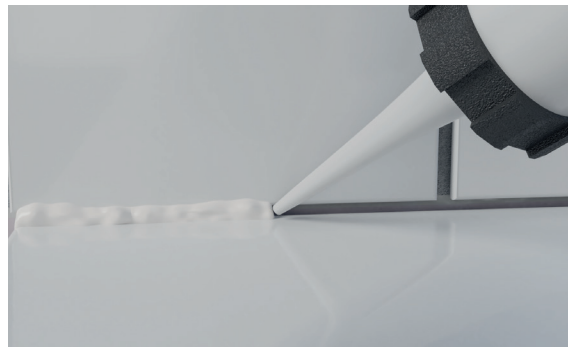

Advantages

- ✓ No filling needed between the 90° corner (wall) and the rounded corner of the shower tray. The gap is filled with silicone.
- ✓ Every tiler has silicone at the job site, it is a familiar product. MS-Polymer is rather new.
- ✓ Self-adhesive backside for easy application.
- ✓ Good movement absorption.
- ✓ Very thin (less thickness underneath the tiles).
- ✓ Butyl-free: temperature and surfactants (tenside) resistant.
- ✓ It's a tiler-solution, not a sanitary-solution.
- ✓ Good compensation of uneven surfaces.
- ✓ Strong bonding between bath tub and wall.
- ✓ Suitable for new bath-/ shower tray installation as well as renovation of existing shower trays.